

Microlab[®] 600 Quick Start Guide

For additional instructions, please refer to the sections in the Basic Manual referenced by each step.



microlab[®]
600 Series

1. Unpack the instrument and verify you have the proper components for your unit. **(Section 2.1)**
2. Select a clean, dry and level location to install the Microlab 600. **(Section 2.2)**
3. Place the syringe drive unit in the desired location. Place the controller on top of the pump and connect the pump and controller with the Ethernet cable.
4. Power the pump and controller by plugging the power supply into an outlet and then into the input on the back of the syringe drive unit. Press the power button on the front of the syringe drive. It will take approximately 30 seconds for the controller to boot up completely.
5. **Valve Installation:**
The Microlab 600 comes with the valves already installed. For a Single Syringe instrument, skip to step 6. For a Dual Syringe instrument, the valve comes with the cross tube installed between the left and right valve. For a Diluter or Continuous Dispenser setup, leave the cross tube in place. For the Dual Syringe Dispenser setup, the cross tube can be removed by detaching the valves, unscrewing the cross tube and reinstalling the valves. **(Section 2.4.1)**

Note: All dual syringe pumps will be configured as a Diluter.

Pre-installed Valve Diagram

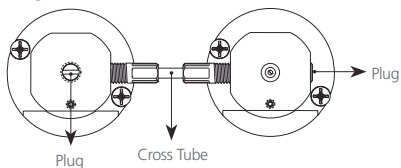

6. **Syringe Installation:**
Press and hold the Prime button. After three seconds, the syringe drive will begin moving down to allow for installation of the syringes. Release the Prime button when the syringes are approximately 50% from the bottom of stroke. Install the syringe(s). **(Section 2.4.2)**

Note: For syringe volumes 10–100 μL , a small PTFE washer is provided. With the plunger at the zero line, place the washer on the top of the syringe to seal between the valve and syringe termination.

Syringe Installation

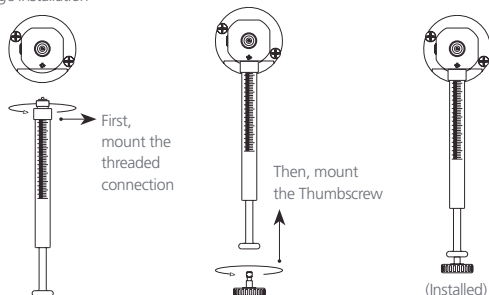

7. **Tubing Installation:**
Install the fill and dispense tubing assemblies as described in **Section 2.4.3** and the drawings below. For the Dual Syringe Dispenser and the Continuous Dispenser setup, this will entail moving the valve plugs according to the diagrams.

Single Syringe Dispenser Valve Assembly

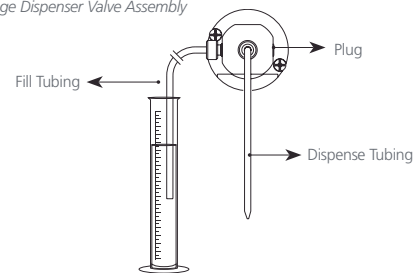

Dual Syringe Diluter Valve Assembly

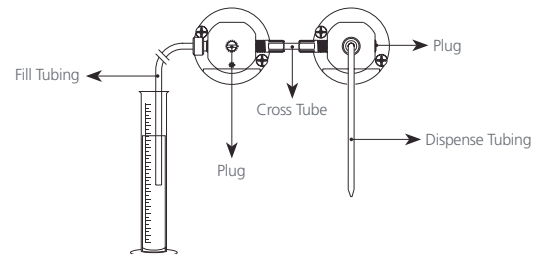

Dual Syringe Dispenser Valve Assembly

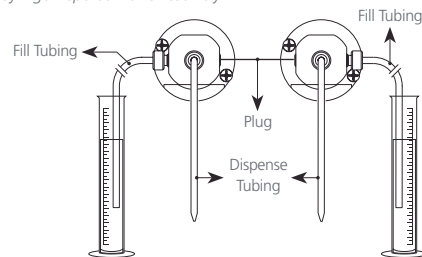

Continuous Dispenser Valve Assembly

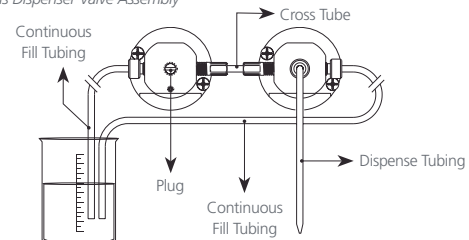

8. Thread the dispense tubing through the hand probe and clips that connect the trigger wire and dispense tubing. Then attach the trigger wire to the probe receptacle on the side of the pump.
9. **Accessory Holder Installation:**
Choose the side of the pump where the Accessory Holder will be installed. Remove the plastic plug screws and install the accessory anchors as described in **Section 2.4.4** and the drawing below. Attach the Accessory Holder to the anchors and thread the tubing and trigger wire through the tubing channel.

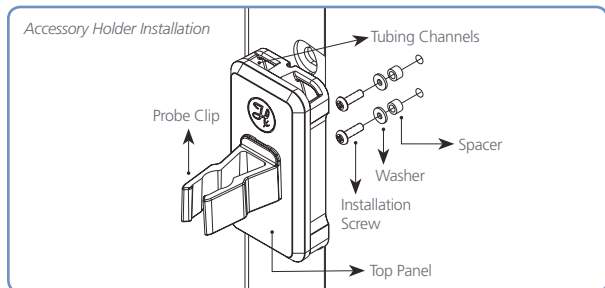

10. Fill a flask or beaker with the liquid to be pumped through the system. Place the fill tubing in the reservoir and affix using a tubing clip.
11. **Software Configuration:**
Using the touchscreen controller, navigate to the Configuration Screen, then select Hardware and set the Syringe volume and Valve type. (**Section 4.2**)



12. **Prime the Instrument:**



Prime Button

Press the Prime button on the front of the syringe drive to fill the syringes with liquid from the reservoir and dispense it out the hand probe to waste. Continue to prime the syringes until all air is flushed from the tubing and syringes. Press the Prime button again to stop the priming. For a Diluter setup, make sure the dispense tubing from the hand probe is submerged in the diluent reservoir to prime the right syringe. (**Section 4.4**)

13. **Basic Operation:**

The hardware is now setup and ready to perform the desired application. For the Basic setup, press the Run button on the bottom left of the Configuration Screen and then select the Quick Start button to begin dispensing. Refer to **Section 4.5** for a detailed description on how the instrument will behave as a Single Syringe Dispenser, Dual Syringe Diluter, Dual Syringe Dispenser or Continuous Dispenser. To complete the Advanced setup proceed to the next step.

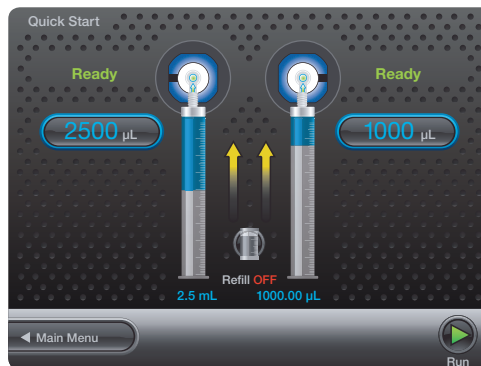

14. **Advanced Operation:**

Install the Hardware Key (SD card) and power the instrument On. If desired, run the Configuration Wizard to configure the hardware, password protection and method logging settings. If these functions are not desired, hit No or Cancel to not be asked again. To install the optional printer, refer to the Quick Start Guide included with the printer. Once the pump is configured, refer to the Advanced manual to determine which Wizard will accomplish the desired application.



Technical Support

If a problem persists even after attempts to correct it, contact Hamilton Company Technical Support or Service Department. To expedite service, please have the instrument part number and serial number ready and available. Please be able to provide application specific information (syringe sizes, drive speeds and liquids).

In the United States and Canada:

Hamilton Company, Inc.
4970 Energy Way
Reno, Nevada 89502
USA

Customer Service
(888) 525-2123

Technical Support/Service
(800) 648-5950

Outside the U.S.
+1 (775) 858-3000

In Switzerland:

Hamilton Bonaduz A.G.
Via Crusch 8
Ch-7402 Bonaduz,
Switzerland

Customer Service
+41 81-660-60-60
Fax +41 81-660-60-70

© 2013 Hamilton Company. All rights reserved.
All trademarks are owned and/or registered by Hamilton Company in the U.S. and/or other countries.
Part Number 61492-01 Rev D



Web: www.hamiltoncompany.com
USA: 800-648-5950
Europe: +41-81-660-60-60

Hamilton Americas & Pacific Rim
Hamilton Company Inc.
4970 Energy Way
Reno, Nevada 89502 USA
Tel: +1-775-858-3000
Fax: +1-775-856-7259
sales@hamiltoncompany.com

Hamilton Europe, Asia, & Africa
Hamilton Bonaduz A.G.
Via Crusch 8
CH-7402 Bonaduz, Switzerland
Tel: +41-81-660-60-60
Fax: +41-81-660-60-70
contact@hamilton.ch

To find a representative in your area, please visit hamiltoncompany.com/contacts.